

Jayco | Alante Class A Motorhome

# ALANTE

COMFORT MEETS DEPENDABILITY



**2+3**  
YEAR | YEAR  
WARRANTY

# INTERIOR DESIGN



## BRIDGEPORT



Wood



Floor



Countertop



Main Fabric

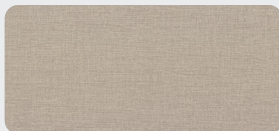

Furniture

## MODERN FARMHOUSE

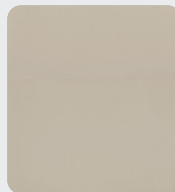

Wood

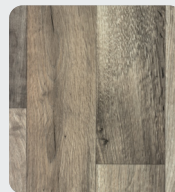

Floor



Countertop

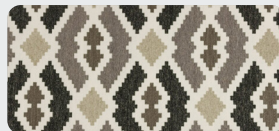

Main Fabric



Furniture

**26X** OPTIONS: C

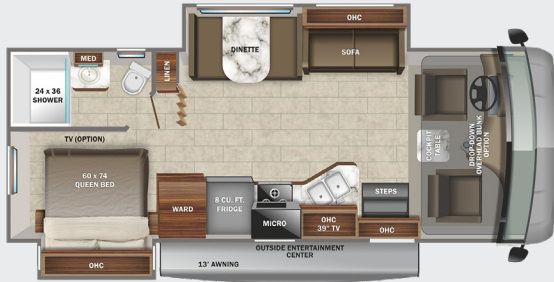

**27A** OPTIONS: A



**29F** OPTIONS: A

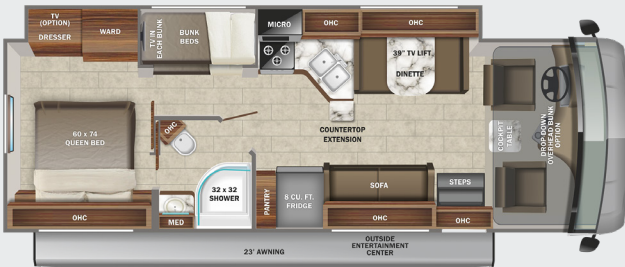

**29S** OPTIONS: A, B

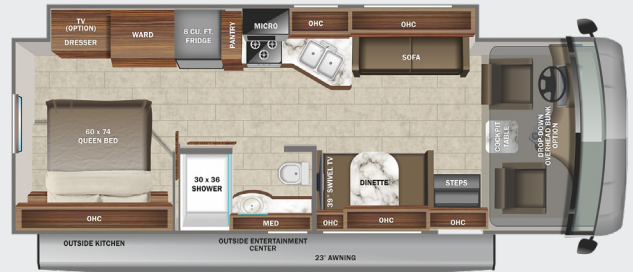

**31V** OPTIONS: A, B

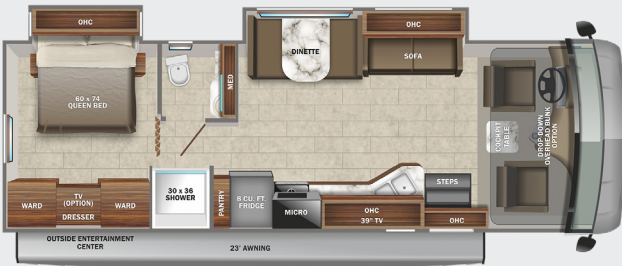

**OPTIONS**

**A**



12 Cu. Ft. Fridge

**B**



Theater Sofa with Cup Holders

**C**



Theater Sofa

# EXTERIOR



Standard Graphics Package

# STANDARDS & OPTIONS

## CUSTOMER VALUE PACKAGE

JRIDE®: Computer-balanced driveshaft, jounce bumpers, heavy-duty front and rear stabilizer bars, SACHS shocks  
 One-piece, crowned fiberglass roof  
 Exterior entertainment center with outside speakers, LED TV mounted on swivel bracket and single-disc DVD/FM radio  
 Electric patio awning with LED lights  
 Slideout cover awnings  
 1,000-watt inverter  
 Sony® infotainment center with Apple® CarPlay™ and Android Auto™  
 Backup and side-view cameras  
 Removable driver/passenger cockpit table  
 LED HD Smart Fire TV in living area  
 Blackout night roller shades

## DRIVING

Ford® F53 chassis  
 GVWR- 16,000 lb. (26X), 18,000 lb. (27A, 29F, 29S, 31V)  
 GCWR- 23,000 lb.  
 7.3L V-8 350 HP engine with 468 ft.-lb. torque  
 6-speed automatic TorqShift® transmission with overdrive and tow haul mode  
 210-amp alternator  
 G-rated highway tires-245/70R19.5  
 Front and rear disc, 4-wheel anti-lock brakes  
 5,000 lb. rear hitch receiver with dual connector and 7-pin plug  
 12V chassis battery  
 80 gal. fuel tank  
 120 in. panoramic windshield - largest in the industry  
 Swivel driver and passenger seats  
 Soft-touch, vinyl-wrapped automotive dash  
 Tilt steering wheel  
 A/C and cruise control

## EXTERIOR

StrongholdVBL™ roof, floor and sidewalls  
 Bead-foam insulation (R-24 max roof, R-9 max floor, R-5 max walls)  
 One-piece, seamless, fiberglass front cap  
 Fiberglass exterior walls with vinyl graphics  
 Automatic hydraulic leveling jacks  
 Frameless windows  
 Entrance door with industry's largest travel-view window  
 Electric-powered entrance step  
 Lockable, pass-through storage compartments with metal slam latches  
 Heated holding tanks (12V pads)  
 16.5 gal. propane tank (56 lb.)  
 LP quick-connect hookup  
 Exterior utility center  
 Winterization drain system  
 Outside shower  
 12V demand water pump  
 Onan® Marquis Gold Genset 4,000-watt gas generator  
 Transfer switch with reverse polarity protection

30-amp electrical service  
 (2) 12V house batteries  
 190W solar panel with dual controller and second house battery  
 Flush-mount LED marker lights  
 Third brake light  
 Porch light  
 4 in. tube bumper with sewer hose storage

## INTERIOR

Power front privacy shade with manual side privacy shades  
 84 in. interior ceiling height  
 High-intensity, recessed LED ceiling lights  
 LED-lit, hardwood fascia  
 Hardwood cabinet doors and drawers  
 Ball-bearing drawer guides  
 Jayco-exclusive, easy-operation legless dinette table  
 2-point lap safety belts in all designated seating locations  
 Dual A/C units with power management system [(1)15,000 on 26X]  
 30,000 BTU auto-ignition ducted furnace  
 Girard® tankless LP water heater  
 Prep for satellite dish  
 Cable TV hookup with RG-6 coax and video selector switch  
 Winegard 2.0 Wi-Fi/4G antenna  
 8 cu. ft., flush-mount, double-door refrigerator  
 Furrion® all-in-one cooktop and oven  
 Residential-size microwave  
 Large stainless steel kitchen sink with cover  
 LED-lit, pressed countertops  
 Flip-up countertop extension (select models)  
 Decorative kitchen backsplash  
 Pop-up charging station in kitchen with 110 outlets and USB ports  
 Water filtration system  
 Shower with decorative surround, glass door, skylight and light  
 Stainless steel bathroom sink  
 Porcelain toilet with foot flush  
 Powered roof vent in bathroom with wall switch  
 Walk-around queen-size bed with bedspread and nightstands (king-size in 27A)  
 Under-bed storage (select models)  
 Powered roof vent in bedroom with wall switch (26X)  
 Large wardrobes  
 Bunks with industry-exclusive 300 lb. capacity each (29F)  
 Smoke alarm  
 Carbon monoxide detector

## OPTIONS

Drop-down overhead bunk in cab area with 750 lb. capacity  
 Theater seating (N/A 27A, 29F)  
 12 cu. ft. gas/electric refrigerator (N/A 26X)  
 Bedroom TV

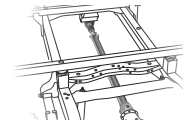

### COMPUTER-BALANCED DRIVESHAFT

Ensures smooth and efficient power transfer to the wheels

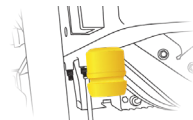

### JOUNCE BUMPERS

Assist during extreme road occurrences to absorb impact and dampen excess road noise

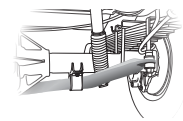

### HEAVY-DUTY FRONT & REAR STABILIZER BAR

A large bar and polyurethane bushings, instead of rubber, transfer power faster for extra support, more stability and easier handling



### SACHS SHOCK ABSORBERS

Large-diameter tube design pairs gas and hydraulics to resist heat and pressure while independently adjusting to changing road conditions

FLOORPLAN	GVWR (lbs.)	GCWR (lbs.)	WHEEL BASE	OVERALL LENGTH	EXTERIOR HEIGHT WITH SATELLITE AND A/C	EXTERIOR WIDTH	INTERIOR HEIGHT	FRESH WATER CAPACITY (gal.)	GRAY WASTE WATER CAPACITY (gal.)	BLACK WASTE WATER CAPACITY (gal.)
26X	16,000	23,000	178"	28' 5"	12' 5"	101"	84"	53	40	32
27A	18,000	23,000	190"	29' 11"	12' 5"	101"	84"	72	50	49
29F	18,000	23,000	190"	32' 2"	12' 5"	101"	84"	72	40	49
29S	18,000	23,000	190"	31' 4"	12' 5"	101"	84"	72	40/9	50
31V	18,000	23,000	190"	32' 2"	12' 5"	101"	84"	72	40	50

Meet your Jayco Dealer



Scan QR code for specification definitions

Some specs at the time of print may include estimates. For the most updated information, please visit [Jayco.com/alante](http://Jayco.com/alante)

Jayco, Inc. | P.O. Box 460 | Middlebury, IN 46540

See dealer for further information and prices. All information in this brochure and on [www.jayco.com](http://www.jayco.com) is the latest available at the time of publication approval. Jayco reserves the right to make changes and to discontinue models without notice or obligation. Photography may show optional equipment or props used for decoration purposes only. RVs built for sale in Canada may differ to conform to Canadian codes. JAYCO and the JAYCO BIRD IN FLIGHT are registered trademarks of Jayco, Inc. Printed in USA 9/21 ©2021 Jayco, Inc. 257070



Jayco - Part of the Jayco Family of Companies